



# UDHOME

## Floor sockets and floor boxes

Elegant, discreet and robust

# Floor sockets and floor boxes

For perfect power and data

The range of UDHOME complete units can position power, data and multimedia technology exactly where they are required. Floor sockets and floor boxes of the UDHOME range are mounted directly on the raw floor and connected with flexible installation pipes – it couldn't be simpler.

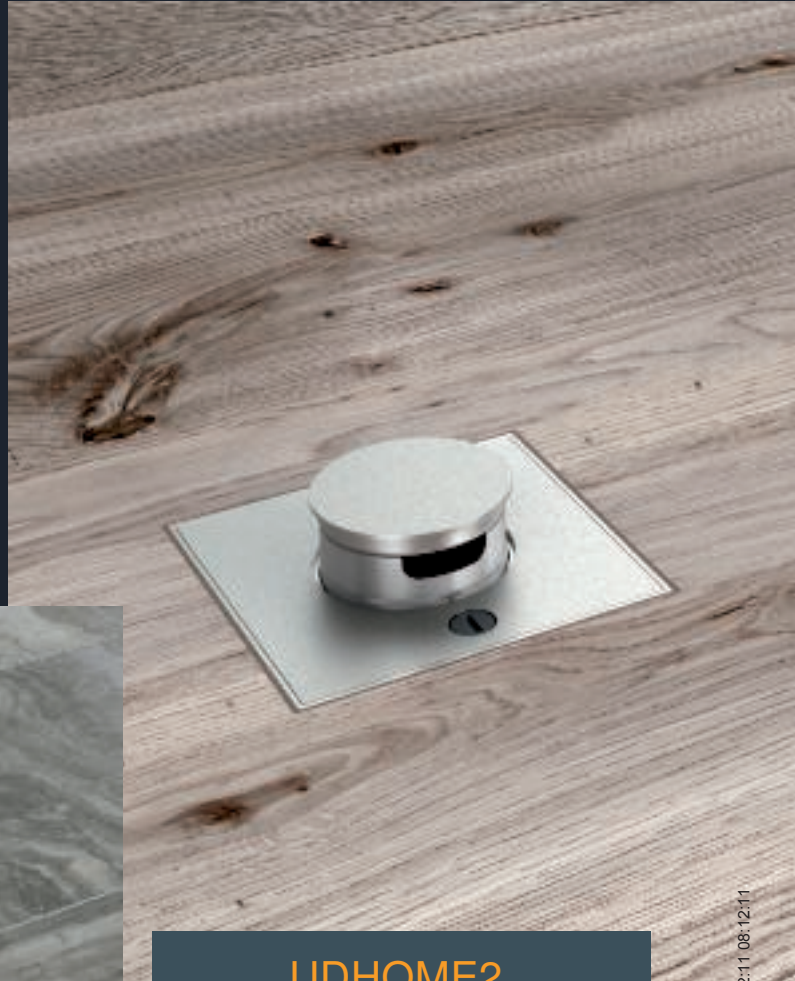

UDHOME2

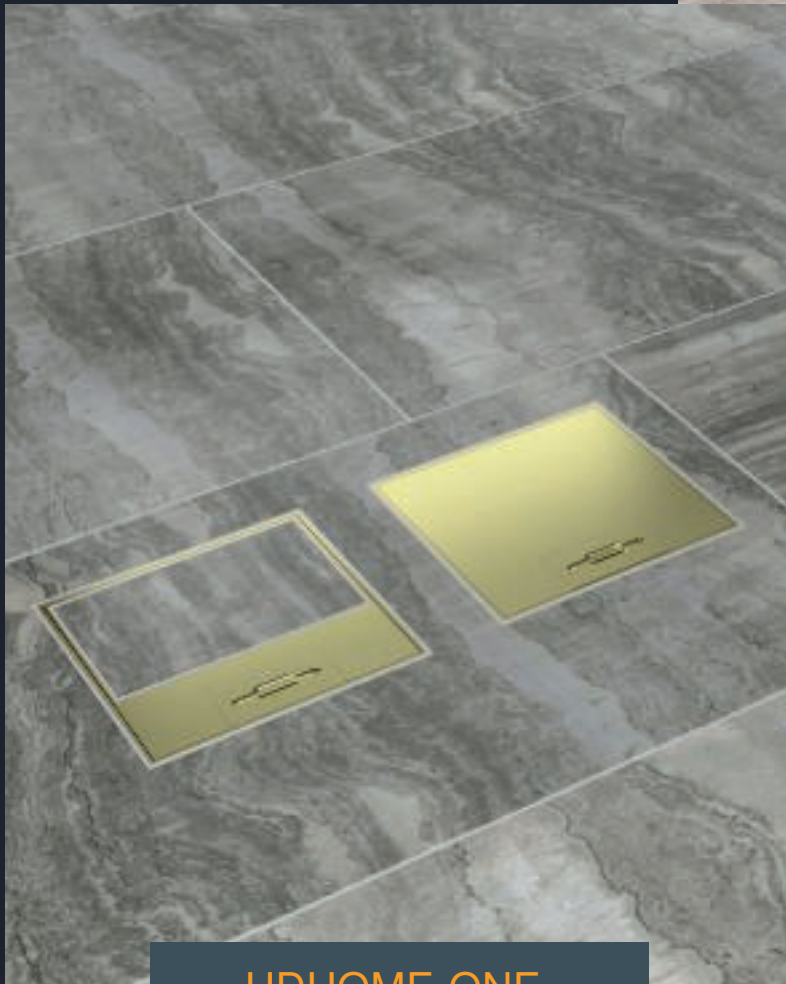

UDHOME-ONE



2:1 08:12:11



UDHOME4

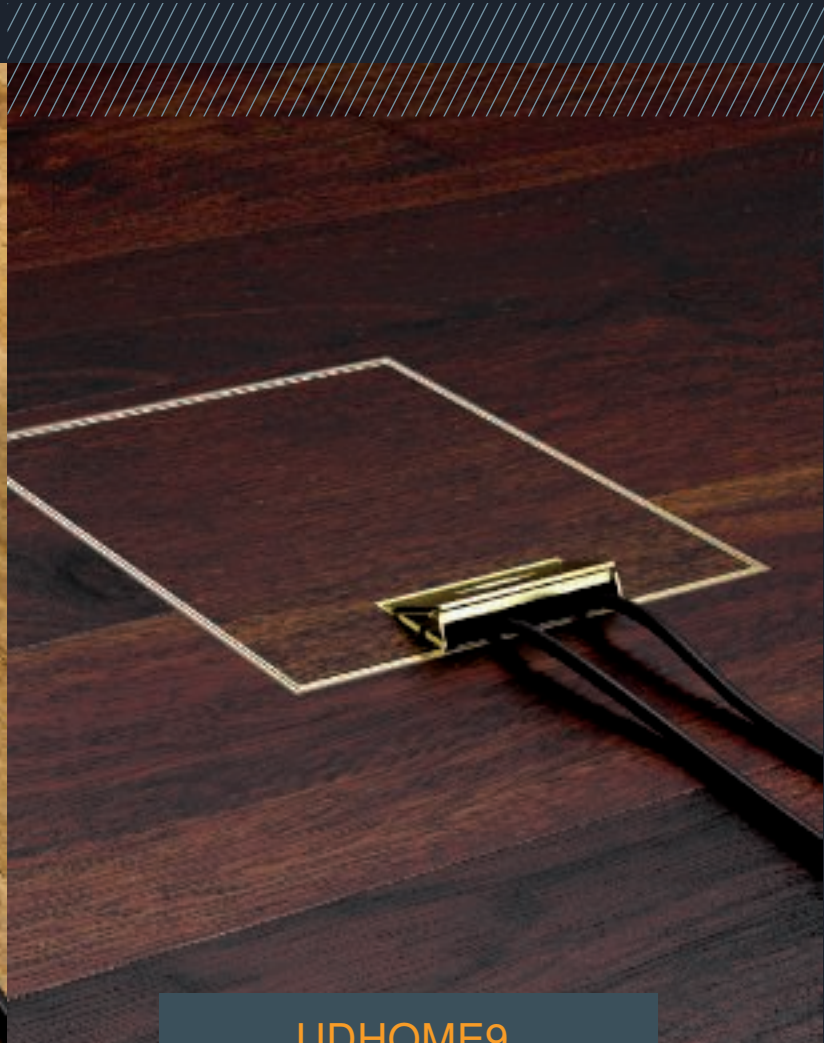

UDHOME9

### Elegant, discreet and robust

Thanks to their elegant, discreet design, UDHOME floor sockets and floor boxes integrate themselves seamlessly into the interior architecture. When the hinged cover is closed, only the high-quality surfaces of pure stainless steel or solid brass are visible. Thanks to their stable construction, the floor sockets and floor boxes are also resistant to the everyday loads in homes, offices and administrative areas.



Easy handling from ordering to mounting



High-quality materials and solid processing



Maximum flexibility in equipment



Produced by using energy from renewable sources

## A special customer: old master in a new light

**Architect: Michele de Lucchi**  
**Museo della Pietà**

Museo della Pietà in Milan is home to the last, uncompleted masterpiece by Michelangelo: the *Pietà Rondanini*. The 89-year-old master worked on the sculpture, which depicts Jesus and Mary, just six days before his death in February 1564.

The compact UDHOME floor sockets and a special solution of OKA trunking from OBO Bettermann provide a discreet and flexible power supply around the famous sculpture.

# Overview of the UDHOME series

## Floor boxes

The UDHOME4 and UDHOME9 floor boxes are the ideal solution for a wide equipment range and dry-cleaned floor coverings. The floor boxes offer a lot of space for the installation of power, data and multimedia connections and are available in discreet stainless steel and in stylish brass.



## Floor sockets

The UDHOME-ONE and UDHOME2 floor sockets, with their dimensions of 125 x 125 mm, combine both elegant appearance and functionality. These two small floor sockets are suitable for both dry and wet-care floors. Stainless steel or brass are used as materials.

# Floor structure

Thanks to their compact design, UDHOME floor sockets and floor boxes require considerably less space and are separate from other electrical installation systems in the floor.

## Height adjustment to floor height

The frame of the UDHOME-ONE and UDHOME2 can be adjusted to the edge of the floor covering using four integrated height-adjustment supports. The height-adjustment range of the UDHOME-ONE is always 75-105 mm, independent from the type of cover. The height-adjustment range is 100/110-135 mm, depending on the cover version. A height extension can be mounted for higher floor structures – additional adjustment range: 10-60 mm.

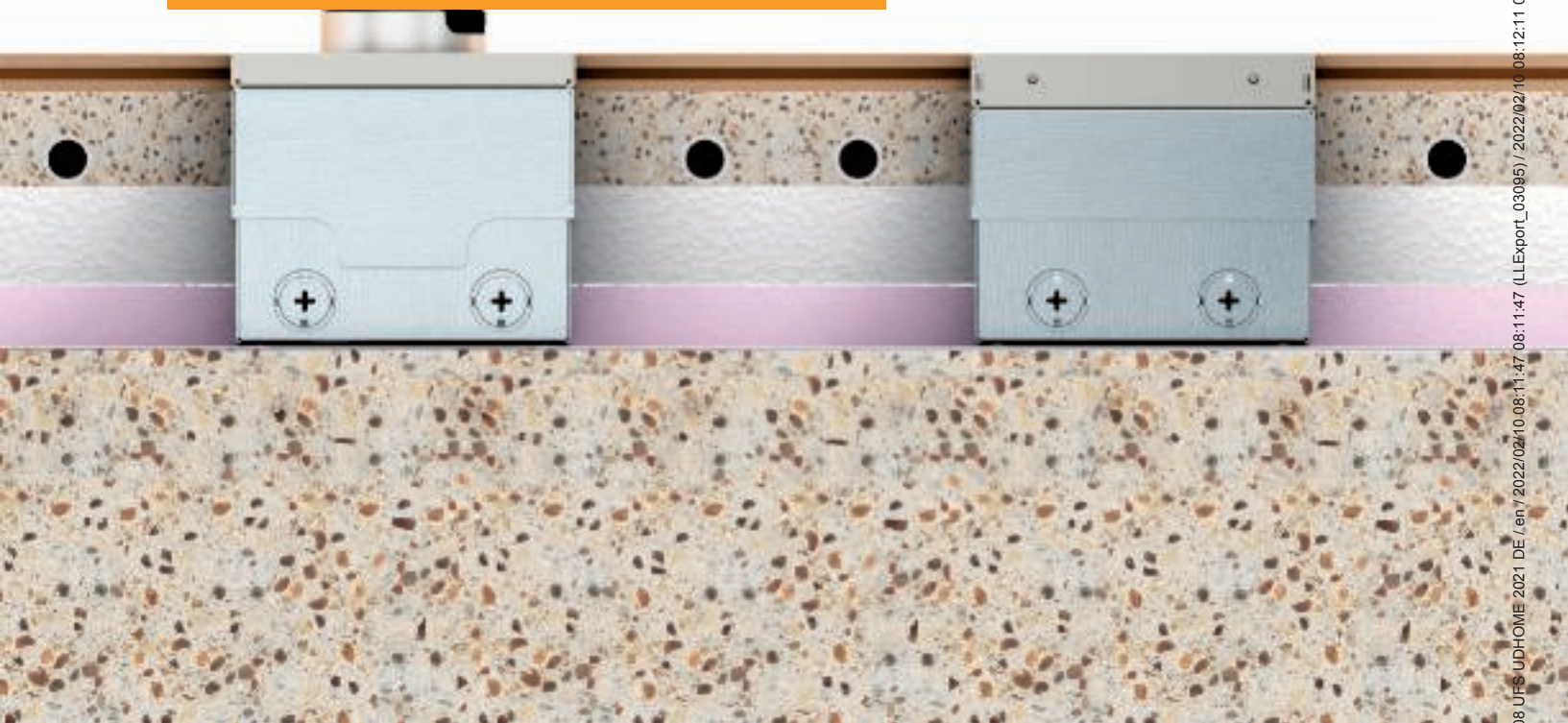



## Tested quality

In addition, OBO tests its trunking and ducts and underfloor sockets in its own BET Test Centre. Thus, special solutions can be tested for their load capacity within a very short time.



## Simple infeed

The feeding in of cables is not complex at all. They are simply run in flexible empty tubes in the screed up to the UDHOME.



08\_UFS\_UDHOME 2021/DE / en / 2022/02/10 08:11:47 08:11:47 (LLExpert\_03095) / 2022/02/10 08:12:11 08:12:11

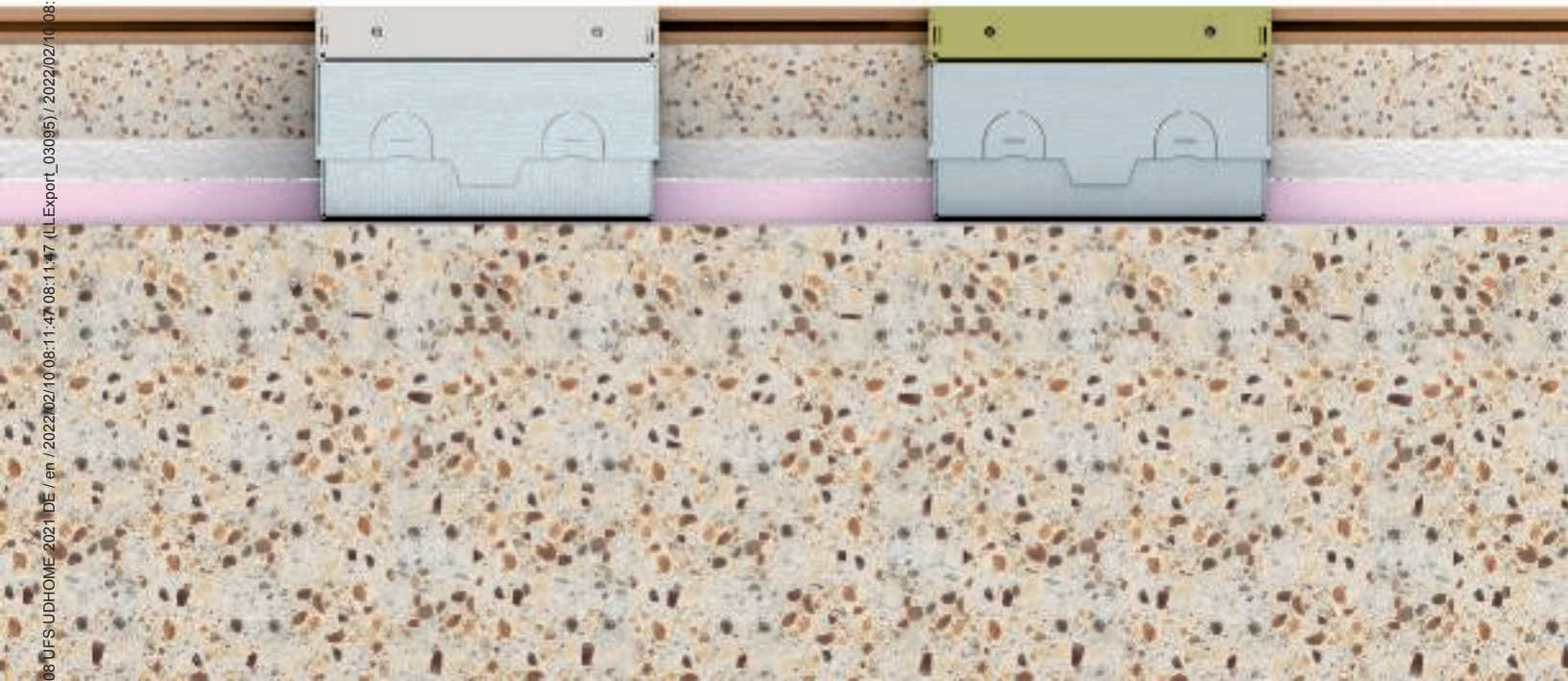

# The UDHOME-ONE floor socket

For use in thin screeds

The smallest and most sustainable member of the product family – even flatter and hence more energy-efficient thanks to the higher heating dynamic.

## Space-saving floor installation

The floor sockets are mounted directly onto the unfinished floor (RFB), connected to flexible installation pipes and then worked flush into the screed. Thanks to the height-adjustment mechanism, the UDHOME-ONE can also be installed in floors of up to 105 mm high.



### The advantages at a glance:

- Can be used in thin screeds from 75 mm
- Sustainable thanks to energy-saving heating in thin screeds
- High load-bearing capacity (up to 15 kN)
- Can be equipped flexibly
- Cover can still be closed when plugs are plugged in
- VDE-certified
- Height-adjustment range of +30 mm



### Device installation - flexible equipment

The floor socket is available either with one data and one power connection or with two power connections. The power connection is made using the Modul 45® series. The cover can still be closed, no matter which connector type is used. At the same time, it is available in two different versions: with floor covering recess (15 mm) and with a decorative plate.

# UDHOME 2 floor socket

Small but perfect

The UDHOME2 floor socket is available with a decorative cover and floor covering recess in stainless steel or brass. With its protection rating of IP45, the UDHOME2 floor socket with tube body and stainless steel cover is even suitable for use in wet-cleaned floors.



## Cover and cord outlet

The larger cord outlet for optimal cable exit can now be opened easily using the handle.

The cover closes with a gentle click and can be used flexibly in all directions.



## Device installation

The scope of delivery for the UDHOME2 contains a double protective contact socket. Up to 2 modular data sockets can be installed with the mounting supports.

The installation space allows all connector types to be used. It is possible to close the cover, even when it is in use.

# The UDHOME4 floor box

For a wide range of equipment



## Device installation

The UDHOME4 can be equipped flexibly with power, data and multimedia technology using 4 support ring devices or 6 Modul 45® devices.



## Height adjustment

The UDHOME has a height-adjustment range of up to 30 mm and can thus be adjusted to the level of the finished floor.

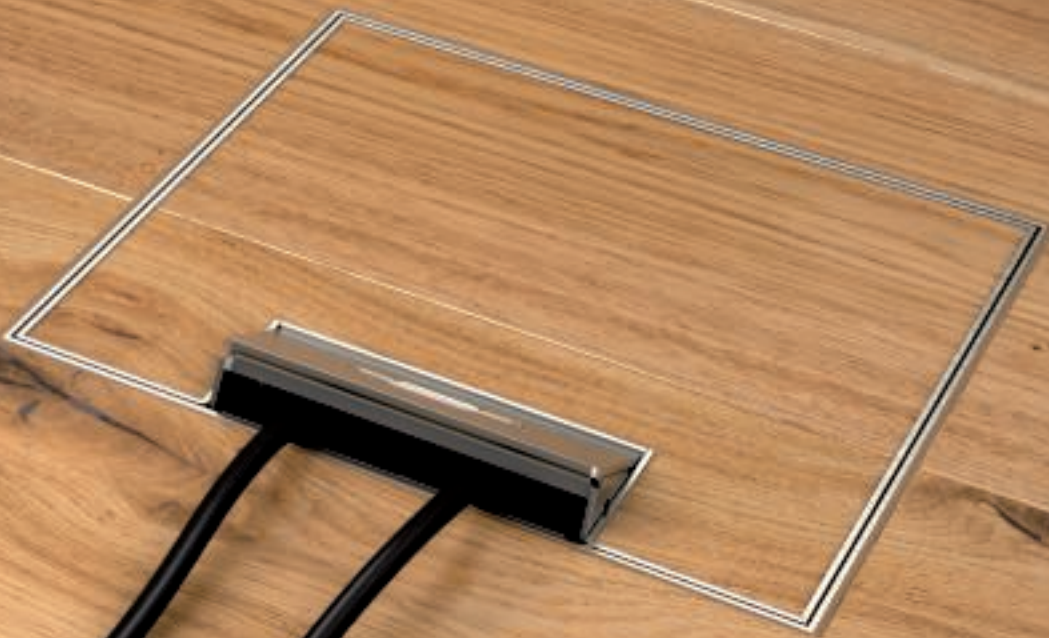

## Design

The UDHOME4 can fit neatly into high-quality interior architecture. All you can see is a slender metal edge and the cord outlet. The floor box is available in stainless steel or brass versions.

# The UDHOME9 floor box

A beautiful figure with powerful connections



## Device installation

The UDHOME9 can be equipped flexibly with power, data and multimedia technology using 9 support ring devices or 12 Modul 45® devices.



## Changeable

The UDHOME9 is available in stainless steel and brass versions.

## Installed

The UDHOME9 is the largest floor box of the UDHOME family. It combines restrained design with a wide range of use options.

# Device installation

The UDHOME range can be equipped flexibly with power, data and multimedia technology. Our extremely comprehensive Modul 45® programme is available for this.

## UDHOME-ONE device installation

The UDHOME-ONE floor sockets are preconfigured with VDE, NF, BS or FLF devices. A variant with an empty mounting support is also available.

Various data technology plates are available for the mounting of the data technology modules.

A double Modul 45® mounting support is available as an accessory for the refitting of a UDHOME-ONE at a later time.

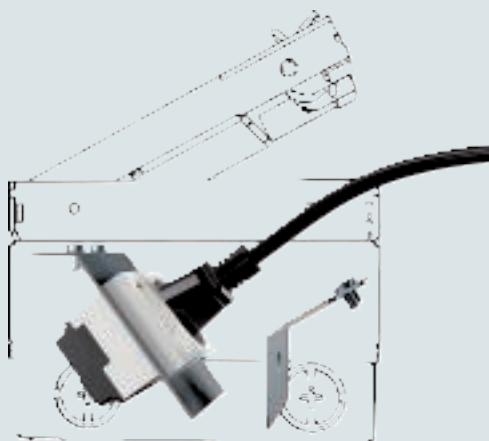

## UDHOME2 device installation

You can order the UDHOME2 floor sockets pre-equipped with a VDE or NF double socket. There is also a version with an empty mounting support for individual equipping.

The installation space of the new UDHOME2 enables the cover to be closed, even when fully loaded with up to 4 connection cables.

In addition, up to 2 data connection modules can be installed in a support, which must be ordered separately.

## Device installation in UDHOME4 and UDHOME9

The UDHOME4 and UDHOME9 floor boxes are available in different pre-configurations. For example, a specific item number indicates that a triple socket is built into the UDHOME.

To meet project-specific requirements, the empty installation spaces of the universal support can be supplemented with additional sockets or data and multimedia technology thanks to the comprehensive Modul 45® product range.





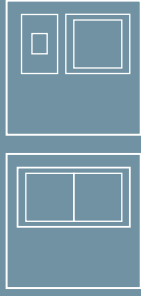

### UDHOME-ONE floor socket

140 x 140 mm  
 1 Modul 45® installation device  
 1 data technology module



Pre-equipped with:  
 1 x Modul 45® socket  
 1 x data technology blanking plate



Data technology plate for optional installation of a data technology module. A mounting support to accept up to 2 Modul 45® installation devices is available as an option



### UDHOME2 floor socket

140 x 140 mm  
 2 Modul 45® devices  
 2 data technology modules



Pre-equipped with  
 2x Modul 45® sockets



Mounting support for data technology for the optional installation of 2 additional data technology modules



### UDHOME4 floor box

199 x 199 mm  
 4 support ring devices  
 6 Modul 45® devices



Option 1: Installation of up to 6 devices when equipped with 2 universal supports (type UT3 45 3)



Option 2: Installation of up to 4 devices when equipped with 2 support ring device supports



### UDHOME9 floor box

243 x 243 mm  
 9 support ring devices  
 12 Modul 45® devices



Option 1: Installation of up to 12 devices when equipped with 3 universal supports (type UT4 45 4)



Option 2: Installation of up to 9 devices when equipped with 3 support ring device supports

## UDHOME-ONE floor socket, with floor covering recess, freely equipable, stainless steel

A2

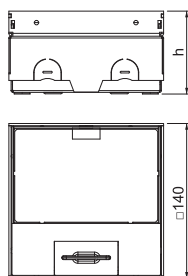

Type	Dim. h mm	Floor height mm	Floor covering thickness mm	Pack Piece	Weight kg/100 pc.	Item no.
UDHOME-ONE GV15	75	75-105	15	1	220.000	7368282

Square floor socket for use in dry-care system and screed floors in indoor areas. Installation housing with pre-marked insertion openings for pipes (M20/M25). Cover adjustable to top edge of floor covering using four height-adjustment supports. The minimum installation depth is 75 mm, the height-adjustment range + 30 mm. Frame and cover made of stainless steel and visible in the floor covering. Cover with floor covering recess.

Empty housing for a Modul 45® installation device and a data socket. When delivered, the item is closed with a blind plate.

## UDHOME-ONE floor socket, with floor covering recess, single VDE socket, stainless steel

A2

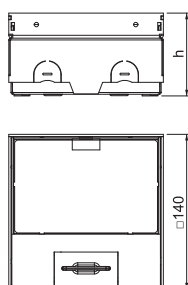

Type	Dim. h mm	Floor height mm	Floor covering thickness mm	Pack Piece	Weight kg/100 pc.	Item no.
UDHOME-ONE GV15V	75	75-105	15	1	220.000	7368290

Square floor socket for use in dry-care systems and screed floors in indoor areas. Installation housing with pre-marked insertion openings for pipes (M20/M25). Cover adjustable to top edge of floor covering using four height-adjustment supports. The minimum installation depth is 75 mm, the height-adjustment range + 30 mm. Frame and cover made of stainless steel and visible in the floor covering. Cover with floor covering recess.

A protective contact socket (VDE) is included in the delivery. A data socket can optionally be installed in the data technology plate. When delivered, the item is closed with a blanking plate.

## UDHOME-ONE floor socket, with floor covering recess, NF socket, stainless steel

A2

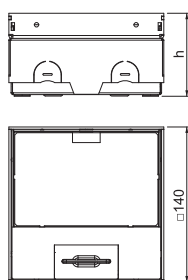

Type	Dim. h mm	Floor height mm	Floor covering thickness mm	Pack Piece	Weight kg/100 pc.	Item no.
UDHOME-ONE GV15N	75	75-105	15	1	220.000	7368294

Square floor socket for use in dry-care systems and screed floors in indoor areas. Installation housing with pre-marked insertion openings for pipes (M20/M25). Cover adjustable to top edge of floor covering using four height-adjustment supports. The minimum installation depth is 75 mm, the height-adjustment range + 30 mm. Frame and cover made of stainless steel and visible in the floor covering. Cover with floor covering recess.

A protective contact socket (NF) is included in the delivery. A data socket can optionally be installed in the data technology plate. When delivered, the item is closed with a blanking plate.

A2

**UDHOME-ONE floor socket, without floor covering recess, freely equippable, stainless steel**

Type	Dim. h mm	Floor height mm	Pack Piece	Weight kg/100 pc.	Item no.
UDHOME-ONE GV	75	75-105	1	220.000	7368280

Square floor socket for use in dry-care system and screed floors in indoor areas. Installation housing with pre-marked insertion openings for pipes (M20/M25). Cover adjustable to top edge of floor covering using four height-adjustment supports. The minimum installation depth is 75 mm, the height-adjustment range + 30 mm. Frame and cover made of stainless steel and visible in the floor covering. Cover with decorative plate.

Empty housing for a 45° installation device and a data socket. When delivered, the item is closed with a blind plate.

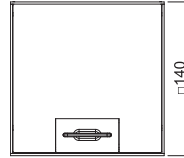
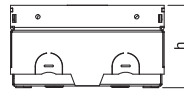

A2

**UDHOME-ONE floor socket, without floor covering recess, single VDE socket, stainless steel**

Type	Dim. h mm	Floor height mm	Pack Piece	Weight kg/100 pc.	Item no.
UDHOME-ONE GV V	75	75-105	1	220.000	7368288

Square floor socket for use in dry-care systems and screed floors in indoor areas. Installation housing with pre-marked insertion openings for pipes (M20/M25). Cover adjustable to top edge of floor covering using four height-adjustment supports. The minimum installation depth is 75 mm, the height-adjustment range + 30 mm. Frame and cover made of stainless steel and visible in the floor covering. Cover with decorative plate.

A protective contact socket (VDE) is included in the delivery. A data socket can optionally be installed in the data technology plate. When delivered, the item is closed with a blanking plate.

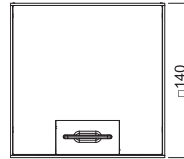
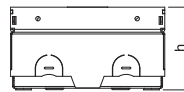

A2

**UDHOME-ONE floor socket, without floor covering recess, NF socket, stainless steel**

Type	Dim. h mm	Floor height mm	Pack Piece	Weight kg/100 pc.	Item no.
UDHOME-ONE GV N	75	75-105	1	220.000	7368292

Square floor socket for use in dry-care systems and screed floors in indoor areas. Installation housing with pre-marked insertion openings for pipes (M20/M25). Cover adjustable to top edge of floor covering using four height-adjustment supports. The minimum installation depth is 75 mm, the height-adjustment range + 30 mm. Frame and cover made of stainless steel and visible in the floor covering. Cover with decorative plate.

A protective contact socket (NF) is included in the delivery. A data socket can optionally be installed in the data technology plate. When delivered, the item is closed with a blanking plate.

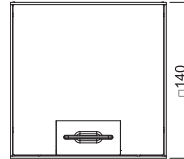
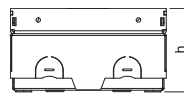

CuZn 37

**UDHOME-ONE floor socket, with floor covering recess, freely equippable, brass**

Type	Dim. h mm	Floor height mm	Floor covering thickness mm	Pack Piece	Weight kg/100 pc.	Item no.
UDHOME-ONE GM15	75	75-105	15	1	220.000	7368286

Square floor socket for use in dry-care system and screed floors in indoor areas. Installation housing with pre-marked insertion openings for pipes (M20/M25). Cover adjustable to top edge of floor covering using four height-adjustment supports. The minimum installation depth is 75 mm, the height-adjustment range + 30 mm. Frame and cover made of brass and visible in the floor covering. Cover with floor covering recess.

Empty housing for a 45° installation device and a data socket. When delivered, the item is closed with a blind plate.

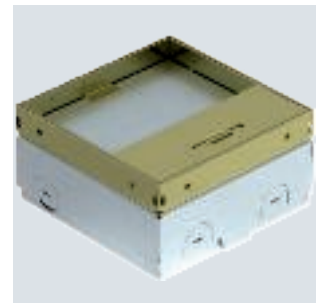
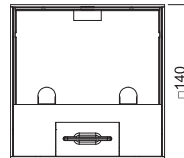
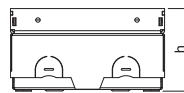

## UDHOME-ONE floor socket, without floor covering recess, freely equippable, brass

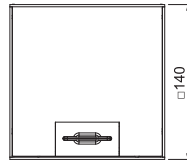
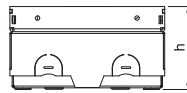
CuZn  
37

Type	Dim. h mm	Floor height mm	Pack Piece	Weight kg/100 pc.	Item no.
UDHOME-ONE GM	75	75-105	1	220.000	7368284

Square floor socket for use in dry-care system and screed floors in indoor areas. Installation housing with pre-marked insertion openings for pipes (M20/M25). Cover adjustable to top edge of floor covering using four height-adjustment supports. The minimum installation depth is 75 mm, the height-adjustment range + 30 mm. Frame and cover made of brass and visible in the floor covering. Cover with decorative plate.

Empty housing for a 45® installation device and a data socket. When delivered, the item is closed with a blind plate.



## UDHOME2 floor socket, with floor covering recess, freely equippable, stainless steel

A2

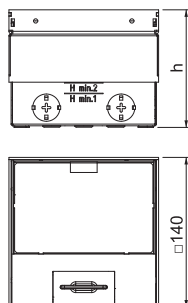
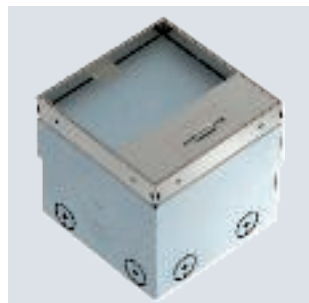

Type	Dim. h mm	Floor height mm	Floor covering thickness mm	Pack Piece	Weight kg/100 pc.	Item no.
UDHOME2 GV15	110	110-135	15	1	230.000	7368340

Square floor socket for use in dry-care cavity and screed floors for indoor use. Installation housing with pre-marked insertion openings for pipes (M20/M25). Cover adjustable to top edge of floor covering using four height-adjustment supports. The minimum installation depth is 110 mm, the height-adjustment range is + 25 mm. Frame and cover made of stainless steel and visible in the floor covering. Up to 2 modular data sockets can be installed in the optional mounting support.

## UDHOME2 floor socket, with tube body, freely equippable, stainless steel

A2

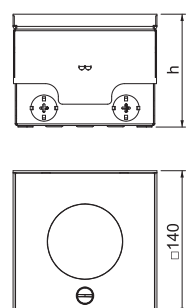

Type	Dim. h mm	Floor height mm	Floor covering thickness mm	Pack Piece	Weight kg/100 pc.	Item no.
UDHOME2 VT2	110	110-135		1	297.000	7427097

Square flush-mount unit for use in dry-cleaned cavity and screed floors. Fitted plug housing with pre-marked insertion openings for pipes (M25). Cover adjustable to top edge of floor covering using four height-adjustment supports. The minimum installation depth is 95 mm, the height-adjustment range + 20 mm. The scope of delivery contains a double socket. Up to two modular data sockets (keystones) can be installed with optional mounting supports.

## UDHOME2 floor socket, with floor covering recess, double VDE, stainless steel

A2

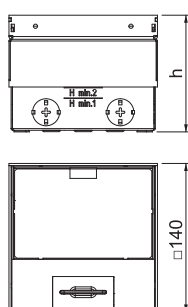

Type	Dim. h mm	Floor height mm	Floor covering thickness mm	Pack Piece	Weight kg/100 pc.	Item no.
UDHOME2 GV15V	110	110-135	15	1	230.000	7368324

Square floor socket for use in dry-care cavity and screed floors for indoor use. Installation housing with pre-marked insertion openings for pipes (M20/M25). Cover adjustable to top edge of floor covering using four height-adjustment supports. The minimum installation depth is 110 mm, the height-adjustment range is + 25 mm. Frame and cover made of stainless steel and visible in the floor covering.

The scope of delivery contains a double protective contact socket. Up to two modular data sockets can be installed in the optional mounting support.

A2



## UDHOME2 floor socket, with floor covering recess, double NF, stainless steel

Type	Dim. h mm	Floor height mm	Floor covering thickness mm	Pack Piece	Weight kg/100 pc.	Item no.
UDHOME2 GV15N	110	110-135	15	1	230.000	7368330

Square floor socket for use in dry-care cavity and screed floors for indoor use. Installation housing with pre-marked insertion openings for pipes (M20/M25). Cover adjustable to top edge of floor covering using four height-adjustment supports. The minimum installation depth is 110 mm, the height-adjustment range is + 25 mm.

Frame and cover made of stainless steel and visible in the floor covering.

The scope of delivery contains a double NF socket.

Up to two modular data sockets can be installed in the optional mounting support.

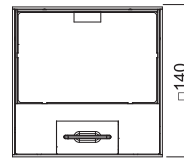
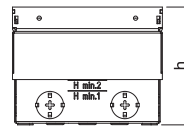

A2



## UDHOME2 floor socket, with tube body, double VDE, stainless steel

Type	Dim. h mm	Floor height mm	Pack Piece	Weight kg/100 pc.	Item no.
UDHOME2 VT2 V	110	110-135	1	297.000	7368409

Square floor socket for use in wet-care cavity and screed floors in indoor areas. Cable exit for height-adjustable tube body. Installation housing with pre-marked insertion openings for pipes (M20/M25). Cover adjustable to top edge of floor covering using four height-adjustment supports. The minimum installation depth is 110 mm, the height-adjustment range is + 25 mm.

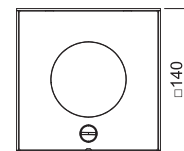
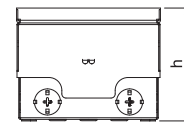

A2



## UDHOME2 floor socket, without floor covering recess, freely equippable, stainless steel

Type	Dim. h mm	Floor height mm	Pack Piece	Weight kg/100 pc.	Item no.
UDHOME2 GV	100	100-135	1	220.000	7368342

Square floor socket for use in dry-care cavity and screed floors for indoor use. Installation housing with pre-marked insertion openings for pipes (M20/M25). Cover adjustable to top edge of floor covering using four height-adjustment supports. The minimum installation depth is 100 mm, the height-adjustment range is + 35 mm.

Frame and cover made of stainless steel and visible in the floor covering. Up to 2 modular data sockets can be installed in the optional mounting support.

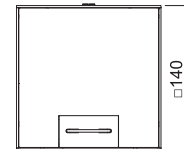
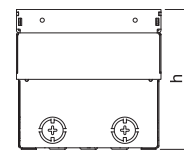

A2



## UDHOME2 floor socket, without floor covering recess, double VDE, stainless steel

Type	Dim. h mm	Floor height mm	Pack Piece	Weight kg/100 pc.	Item no.
UDHOME2 GVV	100	100-135	1	220.000	7368326

Square floor socket for use in dry-care cavity and screed floors for indoor use. Installation housing with pre-marked insertion openings for pipes (M20/M25). Cover adjustable to top edge of floor covering using four height-adjustment supports. The minimum installation depth is 100 mm, the height-adjustment range is + 35 mm.

Frame and cover made of stainless steel and visible in the floor covering.

The scope of delivery contains a double protective contact socket.

Up to two modular data sockets can be installed in the optional mounting support.

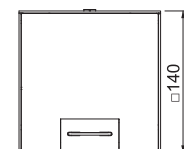
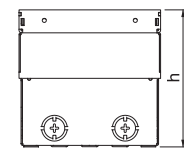

## UDHOME2 floor socket, without floor covering recess, double NF, stainless steel

A2

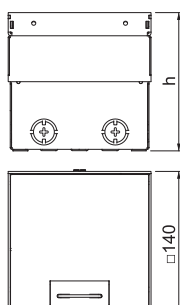

Type	Dim.	Floor	Pack	Weight	Item no.
	h	height		Piece	
UDHOME2 GVN	100	100-135	1	220.000	7368332

Square floor socket for use in dry-care cavity and screed floors for indoor use. Installation housing with pre-marked insertion openings for pipes (M20/M25). Cover adjustable to top edge of floor covering using four height-adjustment supports. The minimum installation depth is 100 mm, the height-adjustment range is + 35 mm. Frame and cover made of stainless steel and visible in the floor covering.

The scope of delivery contains a double NF socket.

Up to two modular data sockets can be installed in the optional mounting support.

## UDHOME2 floor socket, with floor covering recess, freely equippable, brass

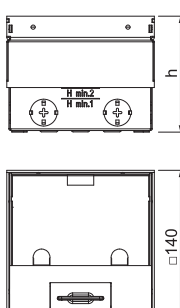
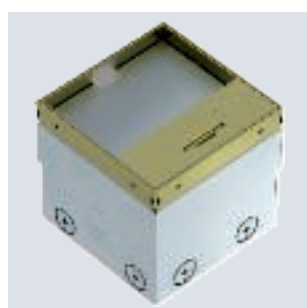
CuZn  
37

Type	Dim.	Floor	Floor	Pack	Weight	Item no.
	h	height	covering		Piece	
UDHOME2 GM15	110	110-135	15	1	230.000	7368346

Square floor socket for use in dry-care cavity and screed floors for indoor use. Installation housing with pre-marked insertion openings for pipes (M20/M25). Cover adjustable to top edge of floor covering using four height-adjustment supports. The minimum installation depth is 110 mm, the height-adjustment range is + 25 mm.

Frame and cover made of brass and visible in the floor covering. Up to 2 modular data sockets can be installed in the optional mounting support.

## UDHOME2 floor socket, without floor covering recess, freely equippable, brass

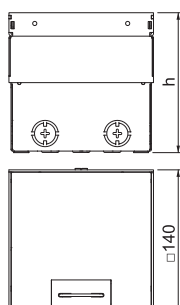
CuZn  
37

Type	Dim.	Floor	Pack	Weight	Item no.
	h	height		Piece	
UDHOME2 GM	100	100-135	1	216.000	7368348

Square floor socket for use in dry-care cavity and screed floors. Installation housing with pre-marked insertion openings for pipes (M20/M25). Cover adjustable to top edge of floor covering using four height-adjustment supports. The minimum installation depth is 100 mm, the height-adjustment range is + 35 mm.

Frame and cover made of brass and visible in the floor covering. Up to 2 modular data sockets can be installed in the optional mounting support.



St



## Height extension for UDHOME-ONE/UDHOME2 floor socket

Type	Pack Piece	Weight kg/100 pc.	Item no.
HE 60UH2	1	71.600	7368418

Height-adjustable extension for UDHOME-ONE/UDHOME2 floor socket. Load capacity up to 8 kN. Additional height-adjustment range: 10–60 mm

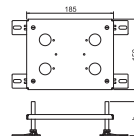

A2



## UDHOME-ONE mounting support for 2 Modul 45® installation devices

Type	Pack Piece	Weight kg/100 pc.	Item no.
MT UH1 2M45	1	7.800	7368485

Mounting support to accept up to two Modul 45® installation devices. Dimensions of the mounting opening: 40 x 115 mm



A2



## UDHOME-ONE data technology plate, type A

Type	Pack Piece	Weight kg/100 pc.	Item no.
DTP UH1 A	1	1.700	7368490

Data technology plate to accommodate one data connection module of type A: AMP TYCO: Standard 110Connect, SL Series 110Connect and Toolless, AMP-Twist; Brand-Rex: unshielded; GG45; TKM RJ MOD; Nexans: LANmark with Adapter-Clip; Siemon CAT6; 3M K6 and K10.  
Dimensions of the mounting opening: 14.8 x 20.1 mm

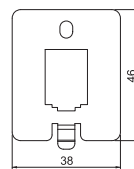

A2



## UDHOME-ONE data technology plate, type B

Type	Pack Piece	Weight kg/100 pc.	Item no.
DTP UH1 B	1	1.700	7368492

Data technology plate to accommodate one data connection module of type B: E-DAT; Dätwyler: MS and MS-N; Kerpen: VarioKeystone.  
Dimensions of the mounting opening: 21.55 x 14.85 mm

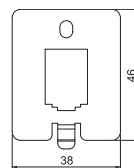

A2



## UDHOME-ONE data technology plate, type C

Type	Pack Piece	Weight kg/100 pc.	Item no.
DTP UH1 C	1	1.700	7368494

Data technology plate to accommodate one data connection module of type C: Brand-Rex: shielded; EKU: E-Stone; Dätwyler: KS-T, MS-K and KU-T; R&M: Snap-In and Keystone; Rutenbeck: UM and UMflex; SETEC: MKJ, UKJ and XKJ; Siemon TERA; Telegärtner: AMJ and UMJ.  
Dimensions of the mounting opening: 14.8 x 19.3 mm

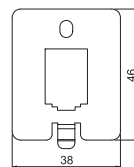

## UDHOME-ONE data technology plate, type F

A2

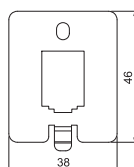

Type	Pack Piece	Weight kg/100 pc.	Item no.
<b>DTP UH1 F</b>	1	1.800	<b>7368498</b>

Data technology plate to accommodate one data connection module of type F: Avaya/Systemax: M series. Dimensions of the mounting opening: 16.6 x 19.3 mm

## UDHOME-ONE data technology plate, type LE

A2

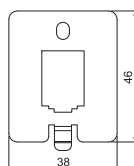

Type	Pack Piece	Weight kg/100 pc.	Item no.
<b>DTP UH1 LE</b>	1	1.700	<b>7368496</b>

Data technology plate to accommodate one data connection module of type LE: LexCom 125 and 250. Dimensions of the mounting opening: 18.4 x 17.3 mm

## UDHOME2 data technology support type A

A2

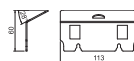

Type	Pack Piece	Weight kg/100 pc.	Item no.
<b>DT UH2 A</b>	1	9.300	<b>7368470</b>

Mounting support to accommodate two data connection modules of type A: AMP TYCO: Standard 110Connect, SL Series 110Connect and Toolless, AMP-Twist; Brand-Rex: unshielded; GG45; TKM RJ MOD; Nexans: LANmark with Adapter-Clip; Siemon CAT6; 3M K6 and K10. Dimensions of a mounting opening in mm: 20.10 x 14.80.

## UDHOME2 data technology support type B

A2

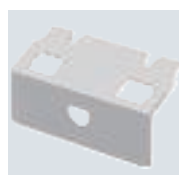

Type	Pack Piece	Weight kg/100 pc.	Item no.
<b>DT UH2 B</b>	1	9.000	<b>7368472</b>

Mounting support to accommodate two data connection modules of type B: E-DAT; Dätwyler: MS and MS-N; Kerpen: VarioKeystone. Dimensions of a mounting opening in mm: 19.35/21.55 x 14.85.

## UDHOME2 data technology support type C

A2



Type	Pack Piece	Weight kg/100 pc.	Item no.
<b>DT UH2 C</b>	1	9.300	<b>7368474</b>

Mounting support to accommodate two data connection modules of type C: Brand-Rex: shielded; EKU: E-Stone; Dätwyler: KS-T, MS-K and KU-T; R&M: Snap-In and Keystone; Rutenbeck: UM and UMflex; SETEC: MKJ, UKJ and XKJ; Siemon TERA; Telegärtner: AMJ and UMJ. Dimensions of a mounting opening in mm: 19.30 x 14.80.

A2



## UDHOME2 data technology support type F

Type	Pack Piece	Weight kg/100 pc.	Item no.
DT UH2 F	1	9.600	7368476

Mounting support to accommodate two data connection modules of type F: Avaya/Systemax: M series.  
Dimensions of a mounting opening in mm: 17.40 x 16.60.

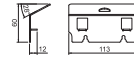

A2



## UDHOME2 data technology support type LE

Type	Pack Piece	Weight kg/100 pc.	Item no.
DT UH2 LE	1	9.300	7368478

Mounting support to accommodate two data connection modules of type LE: LexCom 125 and 250.  
Dimensions of a mounting opening in mm: 18.30 x 17.20.

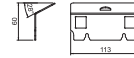

## UDHOME4 floor box, freely equippable, stainless steel

VA

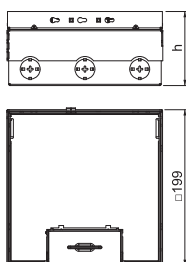
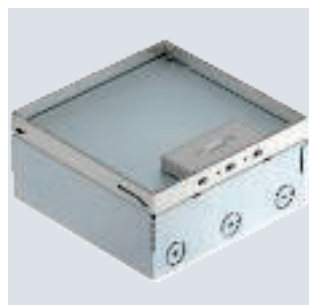

Type	Dim.	Floor	Floor	Pack	Weight	Item no.
	h	height	covering			
	mm	mm	mm	Piece	kg/100 pc.	
<b>UDHOME4 2V</b>	95	95-125	15	1	384.000	<b>7427232</b>

Square floor box for use in dry-cleaned cavity and screed floors in indoor areas. Installation housing with pre-marked insertion openings for pipes (M25). Cover adjustable to top edge of floor covering using four height-adjustment supports. The minimum installation depth is 95 mm, the height-adjustment range + 30 mm.

Surfaces visible in the floor covering made of stainless steel.

## UDHOME4 floor box, with universal support UT3, triple VDE, stainless steel

VA

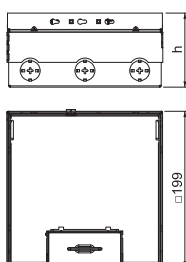
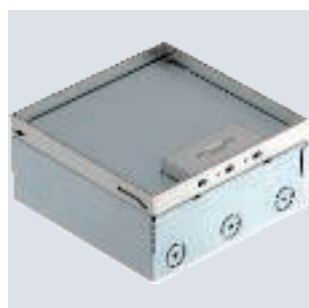

Type	Dim.	Floor	Floor	Pack	Weight	Item no.
	h	height	covering			
	mm	mm	mm	Piece	kg/100 pc.	
<b>UDHOME4 2V V</b>	95	95-125	15	1	380.000	<b>7427200</b>

Square floor box for use in dry-cleaned cavity and screed floors for indoor use. Installation housing with pre-marked insertion openings for pipelines (M25). Cover adjustable to the top edge of the floor covering using four height-adjustment supports. The minimum installation depth is 95 mm, the height-adjustment range + 30 mm.

Surfaces visible in the floor covering made of stainless steel.

The scope of delivery contains two UT3 universal supports, a triple power socket with cover plate and two individual cover plates for accessories with support ring.

## UDHOME4 floor box, freely equippable, brass

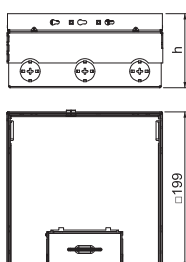
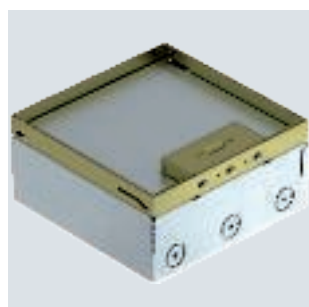
CuZn  
37

Type	Dim.	Floor	Floor	Pack	Weight	Item no.
	h	height	covering			
	mm	mm	mm	Piece	kg/100 pc.	
<b>UDHOME4 2M</b>	95	95-125	15	1	344.800	<b>7427236</b>

Square floor box for use in dry-cleaned cavity and screed floors for indoor use. Installation housing with pre-marked insertion openings for pipelines (M25). Cover adjustable to the top edge of the floor covering using four height-adjustment supports. The minimum installation depth is 95 mm, the height-adjustment range + 30 mm.

Surfaces visible in the floor covering made of brass.

CuZn  
37

## UDHOME4 floor box, with universal support UT3, triple VDE, brass

Type	Dim. h mm	Floor height mm	Floor covering thickness mm	Pack Piece	Weight kg/100 pc.	Item no.
UDHOME4 2M V	95	95-125	15	1	388.000	7427204

Square floor box for use in dry-cleaned cavity and screed floors for indoor use. Installation housing with pre-marked insertion openings for pipelines (M25). Cover adjustable to the top edge of the floor covering using four height-adjustment supports. The minimum installation depth is 95 mm, the height-adjustment range + 30 mm.

Surfaces visible in the floor covering made of brass.

The scope of delivery contains two UT3 universal supports, a triple power socket with cover plate and two individual cover plates for accessories with support ring.

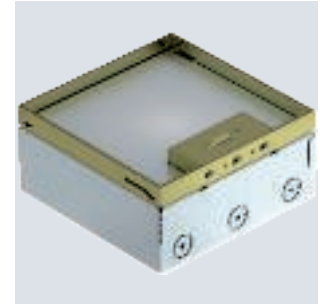
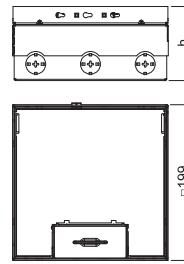

## UDHOME9 floor box, freely equippable, stainless steel

VA

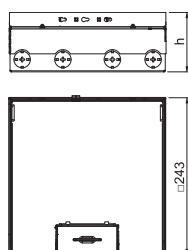
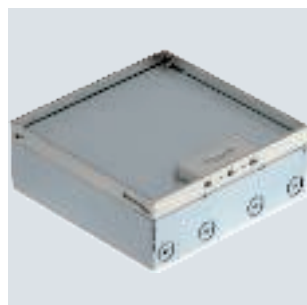

Type	Dim.	Floor	Floor	Pack	Weight	Item no.
	h	height	covering			
	mm	mm	mm	Piece	kg/100 pc.	
UDHOME9 2V	95	95-125	15	1	470.000	7427324

Square floor box for use in dry-cleaned cavity and screed floors for indoor use. Installation housing with pre-marked insertion openings for pipelines (M25). Cover adjustable to the top edge of the floor covering using four height-adjustment supports. The minimum installation depth is 95 mm, the height-adjustment range + 30 mm.

Surfaces visible in the floor covering made of stainless steel.

## UDHOME9 floor box, two double VDE, stainless steel

VA

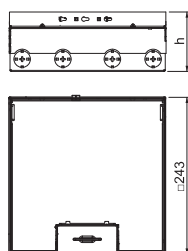

Type	Dim.	Floor	Floor	Pack	Weight	Item no.
	h	height	covering			
	mm	mm	mm	Piece	kg/100 pc.	
UDHOME9 2V UT V	95	95-125	15	1	520.500	7427300

Square floor box for use in dry-cleaned cavity and screed floors for indoor use. Installation housing with pre-marked insertion openings for pipelines (M25). Cover adjustable to the top edge of the floor covering using four height-adjustment supports. The minimum installation depth is 95 mm, the height-adjustment range + 30 mm.

Surfaces visible in the floor covering made of stainless steel.

The scope of supply contains three universal supports UT4 for installation of Modul 45® devices. One universal support is equipped with two double protective contact sockets in pure white. A further universal support is equipped with two cover plates for standard device installation and the third universal support is equipped with two blanking covers.

## UDHOME9 floor box, freely equippable, brass

CuZn 37

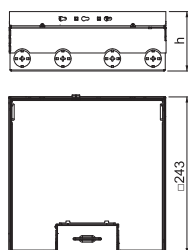
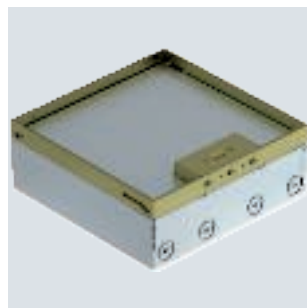

Type	Dim.	Floor	Floor	Pack	Weight	Item no.
	h	height	covering			
	mm	mm	mm	Piece	kg/100 pc.	
UDHOME9 2M	95	95-125	15	1	482.000	7427328

Square floor box for use in dry-cleaned cavity and screed floors for indoor use. Installation housing with pre-marked insertion openings for pipelines (M25). Cover adjustable to the top edge of the floor covering using four height-adjustment supports. The minimum installation depth is 95 mm, the height-adjustment range + 30 mm.

Surfaces visible in the floor covering made of brass.

CuZn  
37

## UDHOME9 floor box, two double VDE, brass

Type	Dim. h mm	Floor height mm	Floor covering thickness mm	Pack Piece	Weight kg/100 pc.	Item no.
UDHOME9 2M UT V	95	95-125	15	1	573.000	7427304

Square floor box for use in dry-cleaned cavity and screed floors for indoor use. Installation housing with pre-marked insertion openings for pipelines (M25). Cover adjustable to the top edge of the floor covering using four height-adjustment supports. The minimum installation depth is 95 mm, the height-adjustment range + 30 mm.

Surfaces visible in the floor covering made of brass.

The scope of supply contains three universal supports UT4 for installation of Modul 45® devices. One universal support is equipped with two double protective contact sockets in pure white. A further universal support is equipped with two cover plates for standard device installation and the third universal support is equipped with two blanking covers.

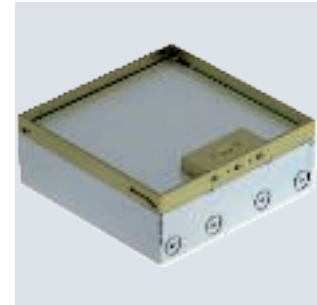
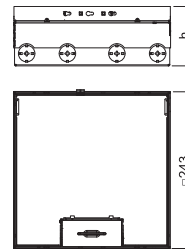

## Accessories, UDHOME floor boxes, stainless steel

St FS



## Height extension for UDHOME4 floor box

Type	Height adjustment range mm	Pack Piece	Weight kg/100 pc.	Item no.
HE60 UDHOME4	10-60	1	109.800	7427440

Height-adjustable expansion for UDHOME4 floor box.

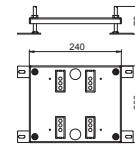

St FS



## Height extension for UDHOME9 floor box

Type	Height adjustment range mm	Pack Piece	Weight kg/100 pc.	Item no.
HE60 UDHOME9	10-60	1	145.700	7427444

Height-adjustable expansion for UDHOME9 floor box.

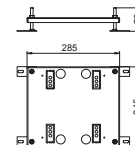

### Connection module Cat. 5, shielded, snap-in

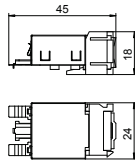

Type	Pack Piece	Weight kg/100 pc.	Item no.
<b>ASM-C5 GS</b>	1	1.920	<b>6117343</b>

Connection module Cat. 5e shielded, with an RJ45 slot. Including an EMC screen hood, a dust cover, a cable tie, a snap-in fastening frame and mounting instructions. Suitable for installation in support plates, type MTM 2C and MTM 3C, mounting plate type MPR2 2C, mounting support type MTGE2 2C, MTGE2 15 2C and MTGE2 F 2C.

### Connection module Cat. 5, unshielded, snap-in

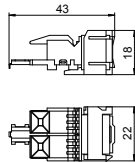

Type	Pack Piece	Weight kg/100 pc.	Item no.
<b>ASM-C5 S</b>	1	1.120	<b>6117347</b>

Connection module Cat. 5e unshielded, with an RJ45 slot. Including a dust cover, a cable tie, a snap-in fastening frame and mounting instructions. Suitable for installation in support plates, type MTM 2C and MTM 3C, mounting plate type MPR2 2C, mounting support type MTGE2 2C, MTGE2 15 2C and MTGE2 F 2C.

### Connection module Cat. 6, shielded, snap-in

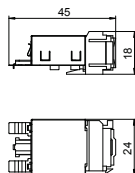

Type	Pack Piece	Weight kg/100 pc.	Item no.
<b>ASM-C6 GS</b>	1	1.850	<b>6117345</b>

Connection module Cat. 6 shielded, with an RJ45 slot. Including an EMC screen hood, a dust cover, a cable tie, a snap-in fastening frame and mounting instructions. Suitable for installation in support plates, type MTM 2C and MTM 3C, mounting plate type MPR2 2C, mounting support type MTGE2 2C, MTGE2 15 2C and MTGE2 F 2C.

### Connection module Cat. 6, unshielded, snap-in

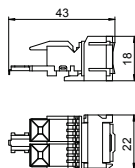

Type	Pack Piece	Weight kg/100 pc.	Item no.
<b>ASM-C6 S</b>	1	1.060	<b>6117349</b>

Connection module Cat. 6 unshielded, with an RJ45 slot. Including a dust cover, a cable tie, a snap-in fastening frame and mounting instructions. Suitable for installation in support plates, type MTM 2C and MTM 3C, mounting plate type MPR2 2C, mounting support type MTGE2 2C, MTGE2 15 2C and MTGE2 F 2C.





**OBO Bettermann Holding GmbH Co. KG**  
P.O. Box 1120  
58694 Menden, Germany

**Customer Service**  
Tel.: +49 23 73 89 - 17 00  
Fax: +49 23 73 89 - 12 38  
[export@obo.de](mailto:export@obo.de)

[www.obo-bettermann.com](http://www.obo-bettermann.com)

---

**Building Connections**

